

Mull-It-Over Sound Barrier Mullion Trim Cap Request for Quote Form

(email RFQ form to marianne@mullitoverproducts.com for pricing)

Project Name: _____
 Project Location: _____
 Project Architect: _____
 Delivery Date: _____
 Check One: STC 55 (unrated) STC 60 (unrated)
 (4 options)
 STC 60 1 hr Fire Rated STC 60 2 hr Fire Rated

SEND QUOTE TO:

Name: _____
 e-mail: _____
 Phone: _____

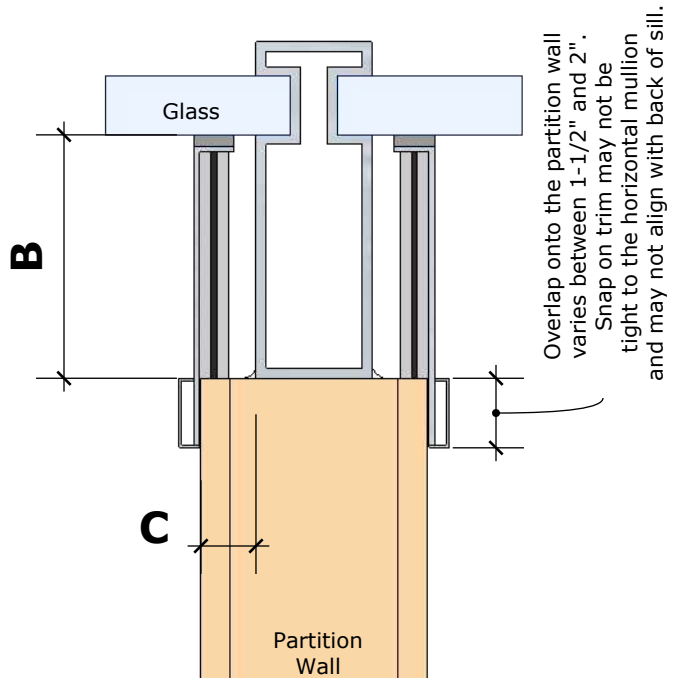
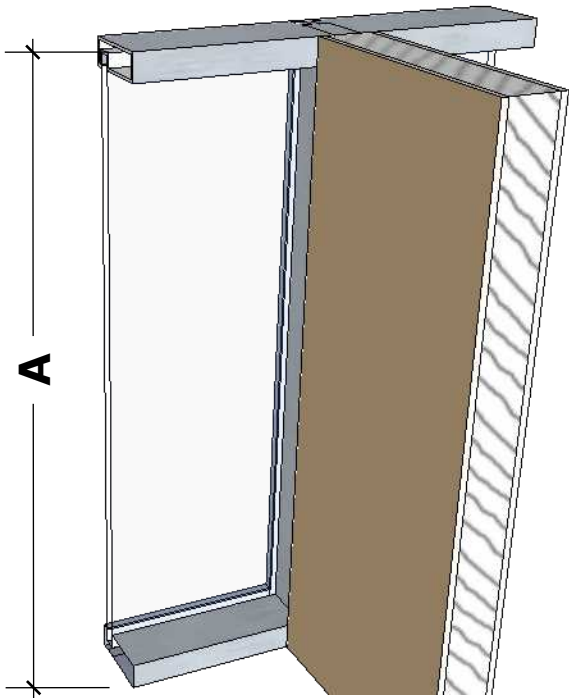

Construct the partition wall the same as if a standard trim were to be installed. Do not stop wall at the back of the sill

A= _____

B= _____

C= _____

Mullion Cap Profile _____

(Classic, Flush, Wide or No Mullion)

(circle one)

Mullion Cap Quantity _____ **Pair / Single

(see note below)

Mullion Cap Finish _____

Mull-It-Over sound barrier mullion trim caps are custom fabricated. Allow adequate time for fabrication.

****Mullion Cap Quantity: Most common detail requires 2 sound barrier mullion trim cap for every partition wall terminated at a vertical mullion.**

Length of Mullion Cap (A) Measure height of vision glass. Add to the length for extending to top or bottom of mullions and sills as detailed by the architect. Recommend ordering the mullion caps long and cutting to length in field to allow for construction tolerance of adjacent systems.

Distance from End of Partition Wall to Interior Face of Glass (B). Maximum distance for a Classic Profile is 8-1/2" and 7-1/2" for a Flush Profile.

Distance from the Face of Mullion to Face of Wall (C) Must be a minimum of 7/8" to use the Classic Profile or Fire Rated Mullion Trim Caps. Select a Mull-It-Over Mullion Trim Cap profile that is compatible. Additional profile option information shown at mullitoverproducts.com