

# Mull-It-Over Sound Barrier Mullion Trim Cap Field Dimension Form

Project Name: \_\_\_\_\_  
 Ship To Address \_\_\_\_\_  
 \_\_\_\_\_  
 Project Architect: \_\_\_\_\_  
 Delivery Date: \_\_\_\_\_

Contractor Contact Info:  
 Name: \_\_\_\_\_  
 e-mail: \_\_\_\_\_  
 Phone: \_\_\_\_\_  
 Contact at Project Site: \_\_\_\_\_  
 \_\_\_\_\_

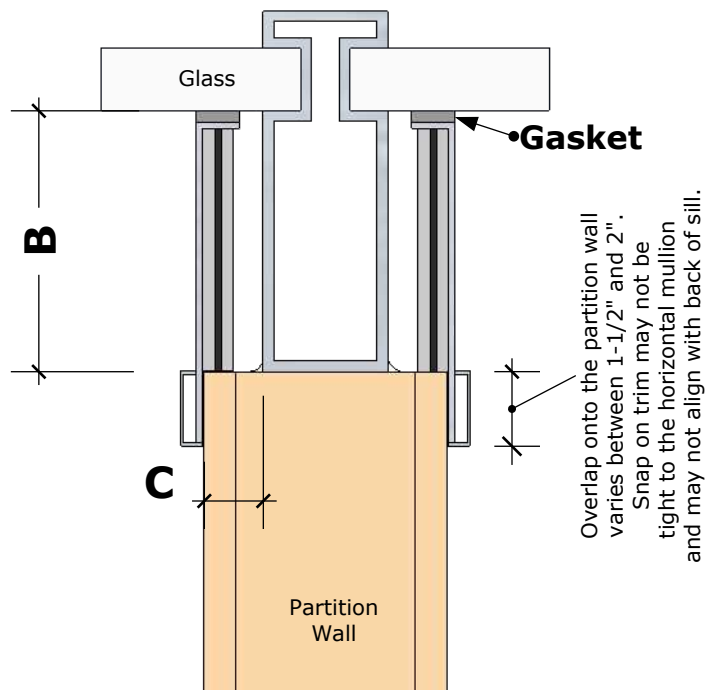
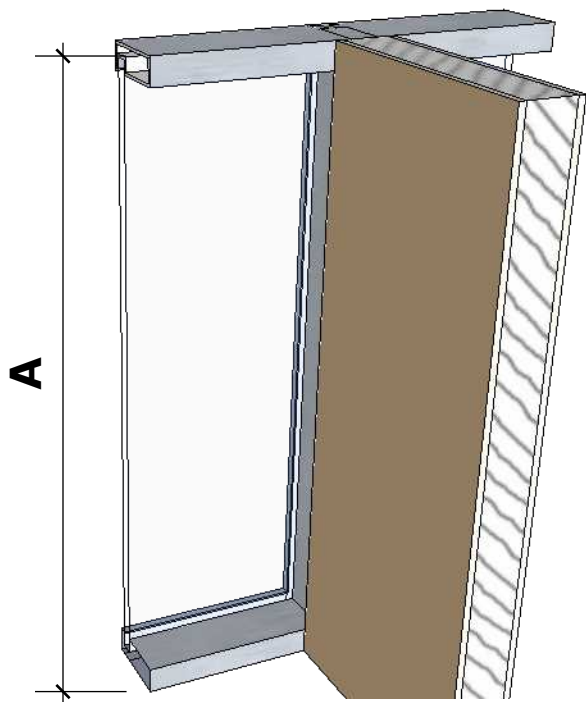

A= \_\_\_\_\_

B= \_\_\_\_\_

C= \_\_\_\_\_

Mullion Cap Profile \_\_\_\_\_  
 (Classic, Flush, Wide, No Mullion or Classic Fire Rated)

Mullion Cap Quantity \_\_\_\_\_

Mullion Cap Finish \_\_\_\_\_

Gasket Options: 1/2" Thick    3/4" Thick    1" Thick    1-1/2" Thick    Light Gray or Charcoal Color  
 (circle selections)

Performance:    STC 55    STC 60    STC 60 1 hour Fire Rated    STC 60 2 Hour Fire Rated

Length of Mullion Cap (A) Measure height of vision glass. Add to the length for extending to top or bottom of mullions and sills as detailed by the architect. Recommend ordering the mullion caps long and cutting to length in field to allow for construction tolerance of adjacent systems.

Distance from End of Partition Wall to Interior Face of Glass (B) Maximum dimension for a Classic Profile is 8-1/2". Maximum dimension for a Flush Profile is 7-1/2". Maximum dimension for Fire Rated is 8".

Distance from the Face of Mullion to Face of Wall (C) Must be a minimum of 7/8" to use the Classic Profile or Fire Rated Mullion Caps. Select a Mull-It-Over Mullion Trim Cap profile that is compatible. Options are Classic, Flush, Wide, No Mullion Non-Fire Rated and Classic Fire Rated profiles. Additional profile option information shown at [mullitoverproducts.com](http://mullitoverproducts.com)